

An Innovative Rapid Test Designed by WANTAI

WHO Prequalified

Rapid Test for Antibody to (HIV 1+2) Human Immunodeficiency Virus

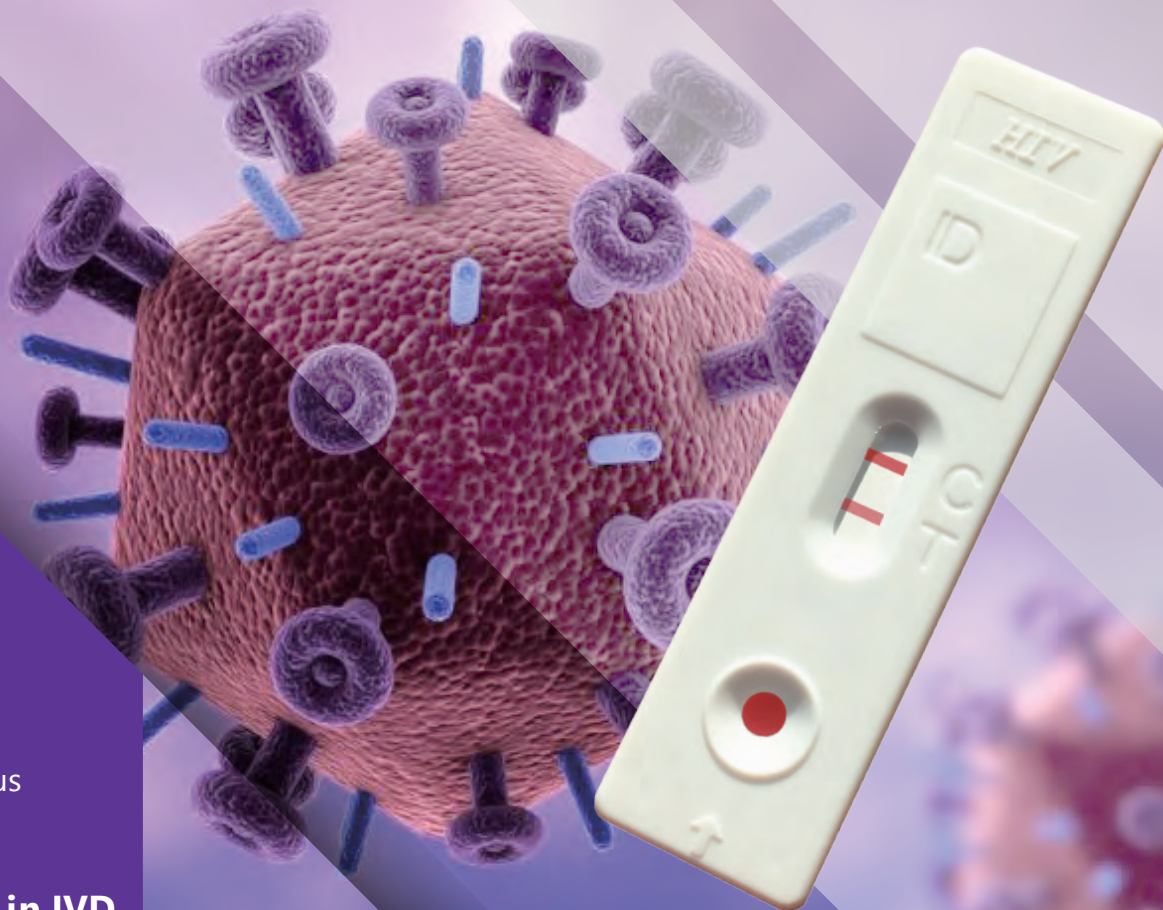

WANTAI

Leading diagnostic test
manufacturer of infectious
diseases

Your Global Partner in IVD

*Developing Scientifically
Focusing on the Health*



Innovative



High Performance



Easy-to-use



Rapid

Test Process

1. Prepare Test

Allow the test cassette to reach room temperature, use it within 20 minutes after opening the pouch.

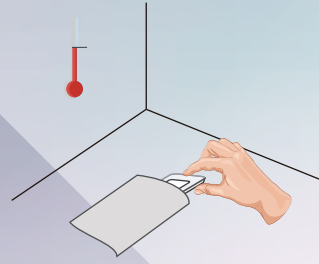

2. Add Specimen

1) **For whole blood specimens**
Add one drop of blood, then
Add one drop of Diluent Buffer

2) **For the serum/ plasma specimens**
Add two drops of specimen

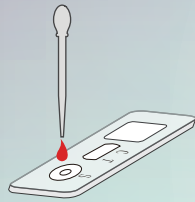

50µl of specimens

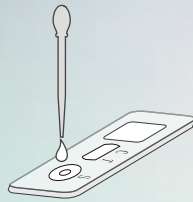

50µl of diluent buffer

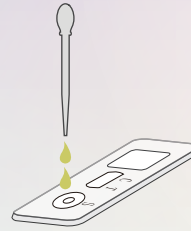

80µl of specimens of S/P

3. Read Result

Read the results within 10-30 minutes.

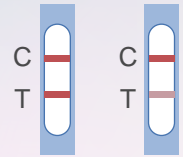

Positive



Negative

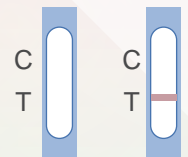

Invalid

* Please refer to product insert for detailed instruction.

Advanced Diagnostic Technology

- 01 Lateral Flow Technology:** makes it possible to perform rapid on-site screening
- 02 Superior Performance:** 100% sensitivity and >99% specificity. Wantai reacts positive to HIV-1 subtypes A, B, C, D, F, G, H, J, K, O, and HIV-2. The test can detect all HIV subtypes in 1st Int.panel for HIV [NIBSC].
- 03 Easy-to-use:** No special equipment. Works with whole blood, serum and plasma samples
- 04 Fast:** clear answer within 10-30 minutes
- 05 All in one:** all accessories in the kit allows to do point-of-care testing
- 06 Room Temperature Storage:** 18 months shelf-life

Order Information

Components	WJ-1810	WJ-1850	WJ-1810E	WJ-1850E
Test Cassette	x 10	x 50	x 10	x 50
Diluent Buffer	x 1 vial	x3 vials	x 1 vial	x 3 vials
Safety Lancet			x 10	x 50
Disposable Pipette			x 10	x 50
Alcohol Pad			x 10	x 50



WANTAI BioPharm