



FULLY AUTOMATED

CHEMILUMINESCENCE IMMUNOASSAY SYSTEM

NMPA Approved

CE Marked

Wan200+

Upgraded · Ingenious · Compelling



Pursuing diligently

“Precise as you **Want** it and steady as Mount **Tai**”

Wan200+ is a new product of Wantai that integrates Japanese design concepts. It is an advanced chemiluminescence technology, with high-quality supporting hardware and intelligent central integrated control system. It inherits high quality and accomplishes the iterative update of functions. By cooperating with other models, it can provide a complete solution for laboratories as well as an improvement of customer experience. Since, after all, it is our unremitting pursuit to bring more precise and steady results for clinical diagnosis.

Smart control interface

ENGLISH/CHINESE

- Touch-screen, English/Chinese interface, IT data management
- Multi-mode testing, balanced loading
- Supports LIS and HIS system interconnection



Specimens rack

15 min

- 150 on-board specimen loading
- Continuous loading
- First results in 29 minutes
- Independent priority slots for immediate loading and testing that provide results in 15 minutes



Consumables

CONTAMINATION

- Single-use PE tips to prevent cross contamination
- Jam-proof cuvette batch loading
- Online loading and switching of consumables in batches

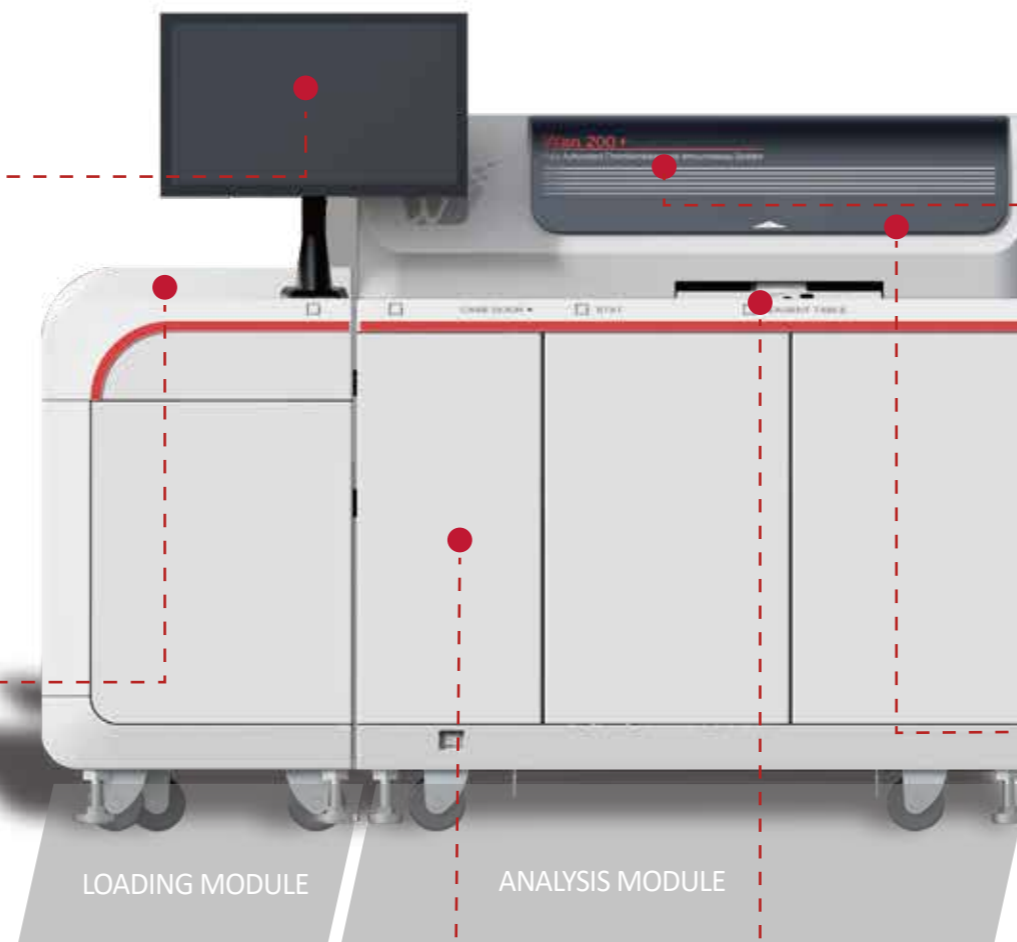

WASHING RACK

CLEAN

- Patented fountain-type spray cleaning technology of needles to eliminate carryover contamination
- Array surrounding magnetic field design
- Ultra-low loss rate of magnetic beads

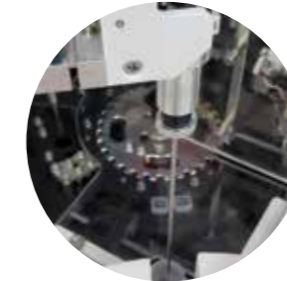

REACTION RACK

GRIPPER

- Precise temperature control in the reaction zone
- Dual disk drive, multiple reaction modes
- New grip structure, fall-proof and jam-proof



REAGENTS RACK

80 24h

- 20 reagent slots in a single model, and extensible to 80 slots
- 24-hour independent refrigeration
- "Enclosed" reagent vial to prevent volatilization
- Real-time and on-board mixing of magnetic beads reagent



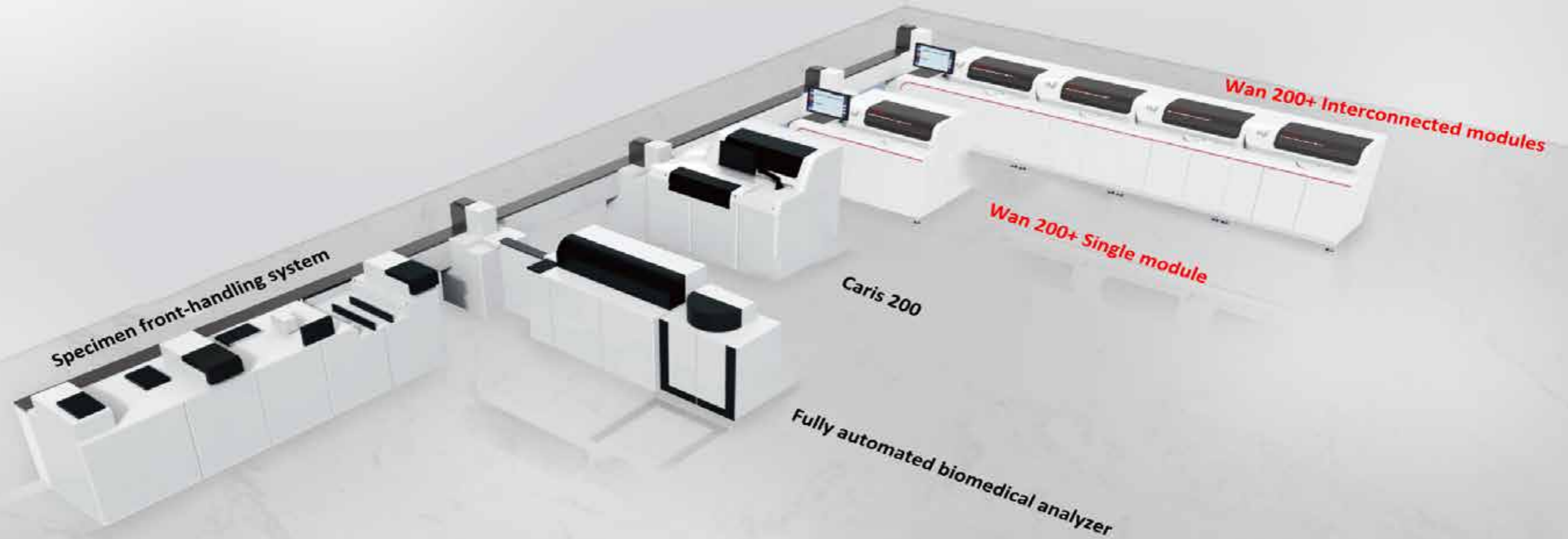

Solution

Integrated Management

Improves in overall the lean management level of laboratories and their quality control standards.

Intelligent coordination

Multi station coordination; intelligent scheduling, unified information management and integrated service

Efficient detection

Intelligent specimen allocation, shortens turnaround time (TAT) and saves personnel resource

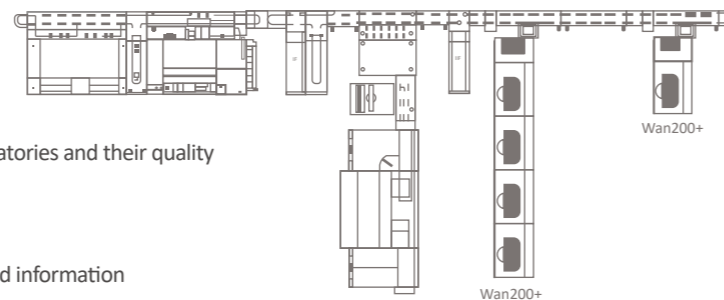

Flexible

Single: 200T/h Multiple: 800T/h

- Modular design with rail docking
- A flexible combination extensible to 4 units
- Equipped with a well-supplied and scalable menu of tests
- Increased throughput and capacity, reaching the best efficiency in a limited time

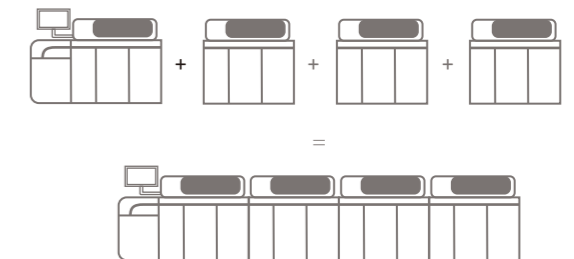

"IoT" for intelligent laboratory management

Personalized management of laboratories

Real-time technical support service

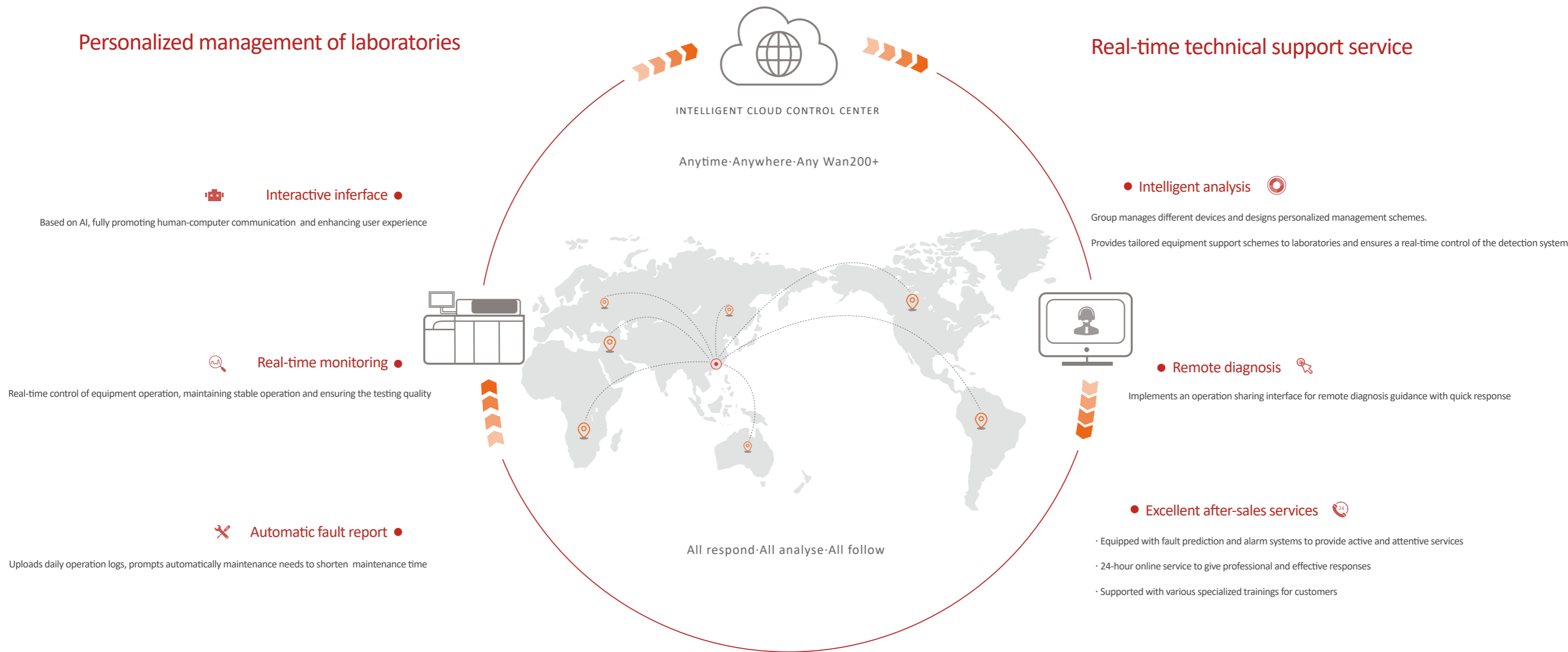

An effective global instrument positioning management

MENU

● Infectious Diseases

HAV Ab
HAV IgM
HBsAg HQ
HBsAg QN
Anti-HBs QN
HBeAg QN
Anti-HBe QN
Anti-HBc QN
Anti-HBc HQ
HBeAg
Anti-HBe
Anti-HBc
Anti-HBc IgM
HBV PreS1
HCV Ab
HDV IgM
HDV IgG
HEV Ag
HEV IgM
HEV IgG
HIV Ag/Ab
TP Ab
EBV NA1 IgA
EBV VCA IgA

EBV Zta IgA

TB-IGRA

2019-nCoV Ab

HTLV Ab

● Tumor Markers

AFP
CEA
f-PSA
T-PSA
c-PSA
CA125
CA15-3
CA19-9
Cy21-1
NSE
SCC
HE4
β2-MG
PG I
PG II
CA50
CA242
CA72-4
S100
ProGRP
PIVKA-II

● Thyroid

TT3
TT4
TSH
FT3
FT4
TG Ab
TPO-Ab
TG

● Hepatofibrosis

HA
P III NP
C IV
LN

● Cardiac Markers

CK-MB
cTnT
cTnl
Myo
Hs-CRP
NT-proBNP
H-FABP

● Hormones

FSH
E2
Prog
T-β-HCG
F-β-HCG
Testo
PRL
LH
AMH
Cortisol
PLGF
PAPPA

● Anemia

Ferritin
sTfR

● Inflammation

PCT
IL-6

● Renal Function

NGAL

● Diabetes

C-Peptide
Insulin

● TORCH

HSV-1 IgG
HSV-1 IgM
HSV-2 IgG
HSV-2 IgM
CMV IgG
CMV IgM
RV IgG
RV IgM
Toxo IgG
Toxo IgM
B19 IgG
B19 IgM

● Others

25-OH-VD
iPTH

Note: Featured products are in bold.
Supporting testing projects are still on their way

Instrument manufacturer: **UMIC 优迈科**

Reagent manufacturer:

innoDx
— 万泰凯瑞 —

TECHNICAL PARAMETERS

- **Principle:** Chemiluminescence Microparticle Immunoassay (CMIA)
- **Marker:** Acridinium Ester
- **Modular design:** Loading module + Analysis module
(Up to 4 independent analytical modules)
- **Central control unit sizes:**
Length: Analysis module: 1180mm; Loading module: 547mm;
Width: 860mm Height: 1300mm
- **Analysis methods:** Sandwich, Indirect, Capture and Competition
- **Specimen type:** Serum, plasma and urine
- **Throughput:** Single analysis module: 200T/h;
4 connected analysis modules: 800T/h.
- **Time:** Ordinary specimens: 29 minutes;
Urgent specimens: 15 minutes
- **Loading method:** Railed rack loading for up to 150 specimens
- **Specimen adding:** Disposable tips
- **Reagent slots:** Single analysis module: 20 reagents
4 connected analysis modules: 80 reagents
- **Reagent storage temperature:** 2~12 °C with independent refrigeration
- **Cuvette:** Single-use cuvettes.
- **Incubation temperature:** 37±0.5 °C; Thermostatic reaction disk
- **Calibration method:** 2-point or 3-point calibration
- **Interface:** English and Chinese
- **Operation methods:** Random or continuous, including priority slots
- **Data management:** IoT and interactive interface

No. 31 Kexueyuan road, Changping
District, Beijing 102206, China

Customer Service: 400-650-5969

Tel:(010)59528888

Fax:(010)89705849

E-mail:ystwt@ystwt.com

Http://www.ystwt.com



Scan QR for additional information